

# Check valves type **SADR**

in-line mounting - from G 1/4" to G 1" threaded ports

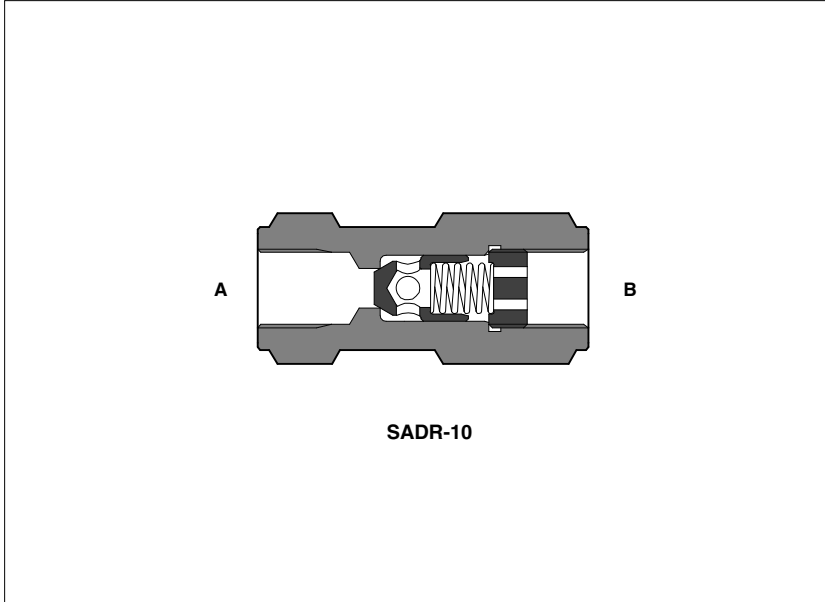

**SADR** are direct operated check valves for in-line mounting available with port size from 1/4" to 1" GAS.

They are designed to operate in hydraulic systems with hydraulic mineral oil or synthetic fluids having similar lubricating characteristics.

Flow up to **360 l/min**  
Pressure up to **400 bar**

## 1 MODEL CODE

|                                 |   |                    |   |          |               |
|---------------------------------|---|--------------------|---|----------|---------------|
| <b>SADR</b>                     | - | <b>10</b>          | / | <b>4</b> | <b>**</b>     |
| Check valve<br>in-line mounting |   |                    |   |          | Series number |
| Size/threaded connections:      |   | Cracking pressure: |   |          |               |
| <b>06</b> = G 1/4"              |   | - =0,5 bar         |   |          |               |
| <b>10</b> = G 3/8"              |   | <b>/2</b> = 2 bar  |   |          |               |
| <b>15</b> = G 1/2"              |   | <b>/4</b> = 4 bar  |   |          |               |
| <b>20</b> = G 3/4"              |   | <b>/8</b> = 8 bar  |   |          |               |
| <b>25</b> = G 1"                |   |                    |   |          |               |

## 2 HYDRAULIC CHARACTERISTICS

|                              |                |                |                |                |                |
|------------------------------|----------------|----------------|----------------|----------------|----------------|
| Hydraulic symbol             |                |                |                |                |                |
| Valve model                  | <b>SADR-06</b> | <b>SADR-10</b> | <b>SADR-15</b> | <b>SADR-20</b> | <b>SADR-25</b> |
| Max recommended flow [l/min] | 40             | 80             | 150            | 300            | 360            |
| Max pressure [bar]           | 400            |                |                | 350            |                |

## 3 MAIN CHARACTERISTICS OF CHECK VALVES TYPE SADR

|                               |  |
|-------------------------------|--|
| Assembly position / location  | Any position   |
| Fluid                         | Hydraulic oil as per DIN 51524 ... 535;  |
| Recommended viscosity         | 15 ÷ 100 mm <sup>2</sup> /s - max allowed range 2,8 ÷ 500 mm <sup>2</sup> /s                   |
| Max fluid contamination level | ISO4406 class 20/18/15 NAS1638 class 9, see also filter section at www.atos.com or KTF catalog |
| Fluid temperature             | -20 ÷ +80°C  |
| Flow direction                | As shown in the symbol at section <a href="#">2</a>  |
| Rated flow                    | See diagrams Q/Δp at section <a href="#">4</a>   |

**4 FLOW VERSUS PRESSURE DROP DIAGRAMS** Based on based on mineral oil ISO VG 46 at 50°C

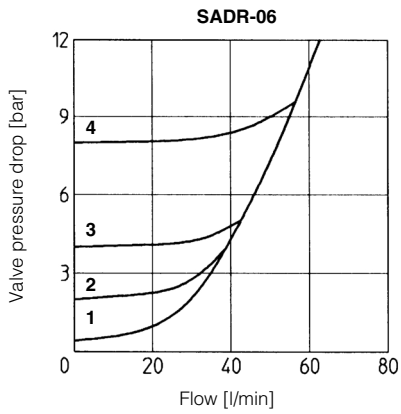

- 1 = SADR-06
- 2 = SADR-06/2
- 3 = SADR-06/4
- 4 = SADR-06/8

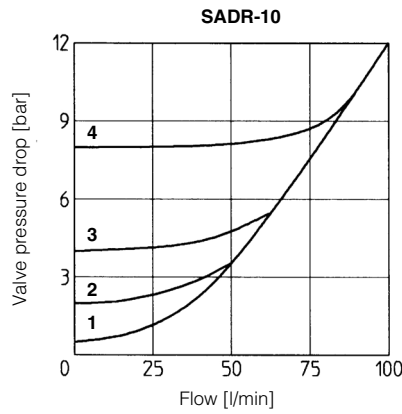

- 1 = SADR-10
- 2 = SADR-10/2
- 3 = SADR-10/4
- 4 = SADR-10/8

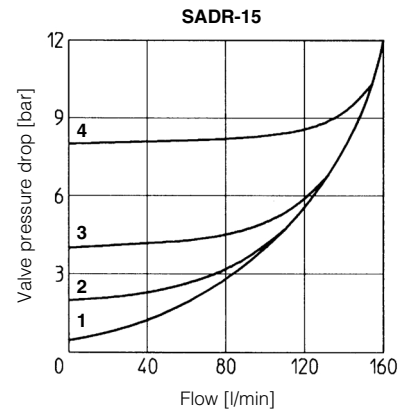

- 1 = SADR-15
- 2 = SADR-15/2
- 3 = SADR-15/4
- 4 = SADR-15/8

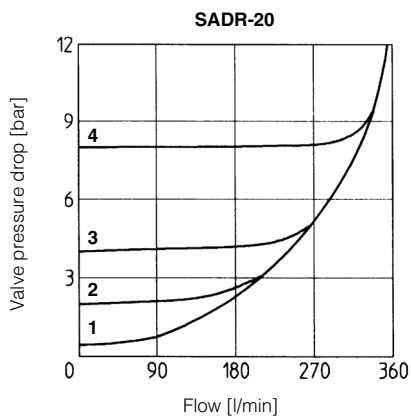

- 1 = SADR-20
- 2 = SADR-20/2
- 3 = SADR-20/4
- 4 = SADR-20/8

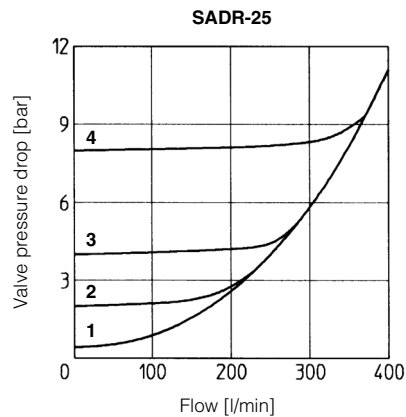

- 1 = SADR-25
- 2 = SADR-25/2
- 3 = SADR-25/4
- 4 = SADR-25/8

**5 DIMENSIONS [mm]**

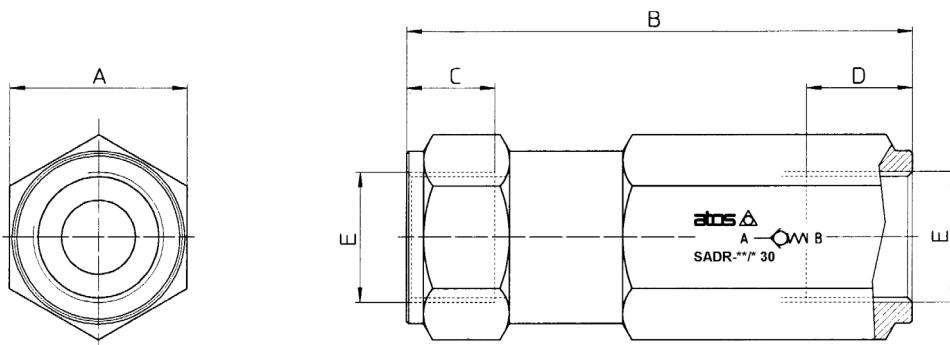

| Model     | A  | B     | C  | D    | E      | Mass [kg] |
|-----------|----|-------|----|------|--------|-----------|
| SADR - 06 | 22 | 67    | 12 | 13   | G 1/4" | 0,2       |
| SADR - 10 | 27 | 70    | 12 | 13   | G 3/8" | 0,4       |
| SADR - 15 | 32 | 82,5  | 14 | 17   | G 1/2" | 0,6       |
| SADR - 20 | 36 | 102,5 | 16 | 21,5 | G 3/4" | 0,9       |
| SADR - 25 | 46 | 120   | 18 | 24,5 | G 1"   | 2,1       |